



Internal Use Only

<http://biz.lgservice.com>

Multi Air Conditioner

SVC MANUAL(Exploded View)

Model : A4UW363FA0 (LMU365HV)

CAUTION

Before Servicing the unit, read the safety precautions in Standard SVC manual.
Only for authorized service personnel.

1. Specification

| Outdoor Unit | | | A4UW363FA0(LMU365HV) |
|---|--------------------------------------|-------------|--------------------------------------|
| Capacity(*) | | Btu/h Class | 36,000 |
| Power Input (Min._Rated~ Max.) | Cooling | kW | 0.72~3.21~ 3.92 |
| | Heating | kW | 0.72~3.7~4.10 |
| Running Current (Rated) | Cooling | A | 3.0~14.2~17.3 |
| | Heating | A | 4.5~16.3~18.5 |
| Starting Current | Cooling/Heating | A | - |
| Power Supply | | Ø / V / Hz | 1/208~230/60 |
| Power Supply Cable (Outdoor) | | No.x AWG | 3 x 12 |
| Transmission Cable (Outdoor to Indoor unit) | | No.x AWG | 4 x 18 (Including Earth) |
| Dimensions | W x H x D | mm(inch) | 870x808x320(34 1/4x31 13/16x12 9/16) |
| Net Weight | | kg(lbs) | 65(143.3) |
| Max. Number of Connectable Indoor Units | | | 4 |
| Compressor | Type | | Twin-Rotary |
| | Qty x Model | | 5KD240X |
| | Motor type | | BLDC |
| | Oil charge volume | cc | 900 |
| | Oil Type | | FV50S |
| Refrigerant | Cycle A Charge (at 7.5m) | g(oz) | 2,550(89.95) |
| | Cycle B Charge (at 7.5m) | g(oz) | - |
| | Type | | R410A |
| Heat Exchanger | Control | | EEV |
| | (Rows x Column x FPI) x No. | | (2Rx36Cx18) x1 |
| | Coil tube dia. | mm(inch) | 7(0.276) |
| | Defrosting Method | | Reversing cycle |
| Fan motor | Capacitor | µ/Vac | - |
| | Drive | | Direct (DC) |
| | Discharge Direction(Side/Top) | | Side |
| | Air Flow Rate x No. of Fan | CMM(CFM) | 60(2,118) |
| Sound Level(H/L) | Sound Pressure | dB(A)+3 | 52 |
| | Liquid(Cycle A) | mm(inch) | 6.35(1/4) x 4EA |
| Piping Connections | Gas(Cycle A) | mm(inch) | 9.52(3/8) x 4EA |
| | Liquid(Cycle B) | mm(inch) | - |
| | Gas(Cycle B) | mm(inch) | - |
| | Piping length spec. | | |
| Max. Elevation Difference | Max. total piping | m(ft.) | 75(246.1) |
| | Max. OD-ID piping | m(ft.) | 25(82.0) |
| | Piping Length (no add'l refrigerant) | m(ft.) | 37.5(123.0) |
| | Outdoor Unit~Indoor Unit | m(ft.) | 15(49.2) |
| | Indoor Unit~Indoor Unit | m(ft.) | 7.5(24.6) |
| Operation Range (Outdoor) | Cooling | °C(°F) | -10 ~ 46 (14 ~114.8) |
| | Heating | °C(°F) | -15 ~ 24 (5~75.2) |

Note :

1. Capacities are based on the following conditions:

- Cooling: - Indoor Temperature 26.7°C(80°F) DB/19.4°C(67°F) WB
- Outdoor Temperature 35°C(95°F) DB/23.9°C(75°F) WB
- Heating: - Indoor Temperature 21.1°C(70°F) DB/15.6°C(60°F) WB
- Outdoor Temperature 8.3°C(47°F) DB/6.1°C(43°F) WB
- Piping Length - Interconnecting Piping Length 7.5m(24.6 ft.)
- Level Difference of Zero

- 2. Wiring cable size must comply with the applicable local and national code.
- 3. The specification may be subject to change without prior notice for purpose of improvement.
- 4. At least two indoor units should be connected.
- 5. For more Capacity(*),refer to the combination table

Conversion Formula

kW = Btu/h class X 0.0002931
cfm = CMM x 35.3

2. List of Functions

| Category | Function | A4UW363FA0(LMU365HV) |
|----------------------|---|----------------------|
| Reliability | Defrost / Deicing | O |
| | High Pressure Switch | X |
| | Low Pressure Switch | X |
| | Phase protection | X |
| | Restart Delay (3-minutes) | O |
| | Self Diagnosis | O |
| | Soft Start | O |
| | Test Function | X |
| Convenience | Auto operation(Artificial intelligence) | O |
| | Auto Restart Operation | O |
| CAC Network Function | Central control(LGAP) | X |
| | PDI(Power Distribution Indicator) | X |
| | PI485 | X |
| Special function kit | Low ambient operation | O |
| Others | Thermistor | - |

Note :

O : Applied, X : Not applied, – : No relation

Option: Model name & price are different according to options, and assembled in factory with main unit.

Accessory: Installed at field, ordered and purchased separately by the corresponding model name, supplied with separate package.

3. Piping Diagrams

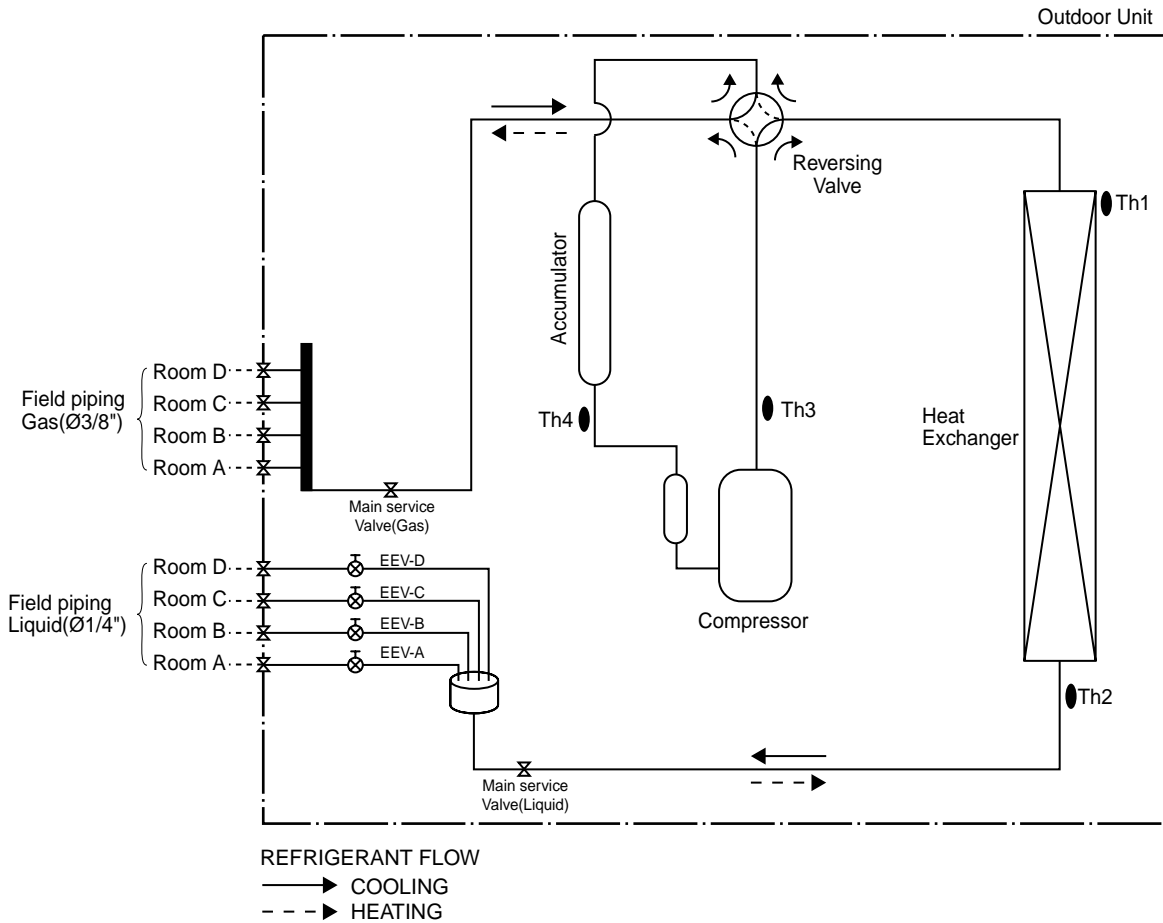

| LOC. | Description | PCB Connector |
|------|---|---------------|
| Th1 | Thermistor for outdoor air temperature | CN_TH2 |
| Th2 | Thermistor for condensing temperature | CN_TH2 |
| Th3 | Thermistor for discharge pipe temperature | CN_TH3 |
| Th4 | Thermistor for suction pipe temperature | CN_TH3 |

4. Wiring Diagrams

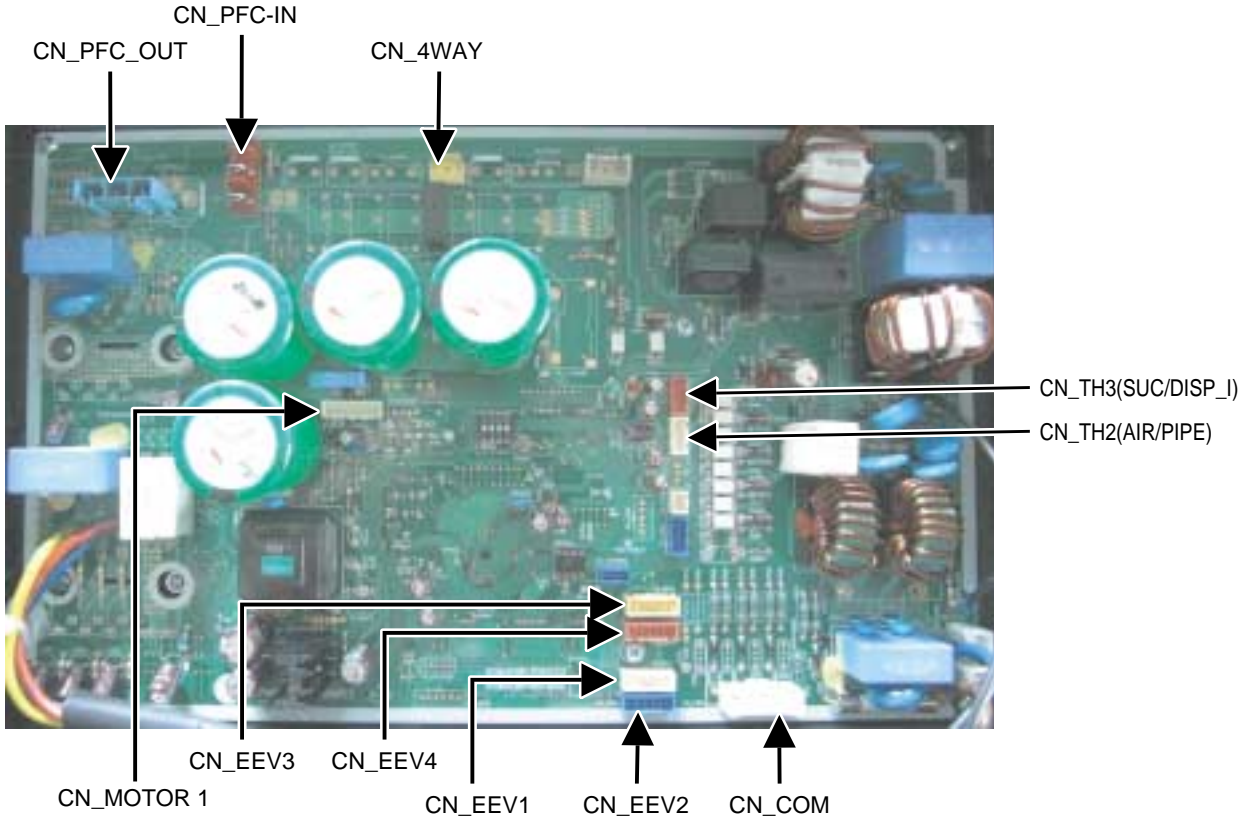
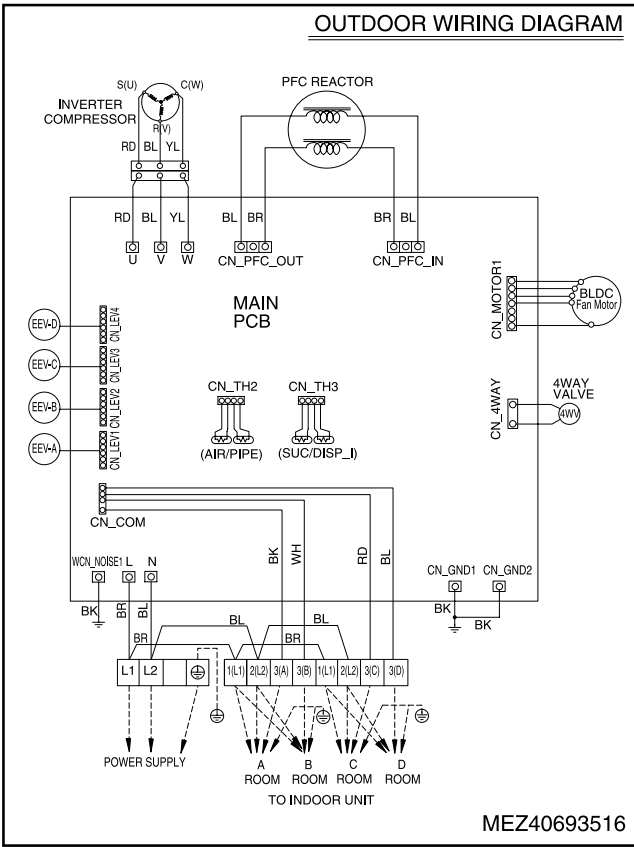

5. Exploded View

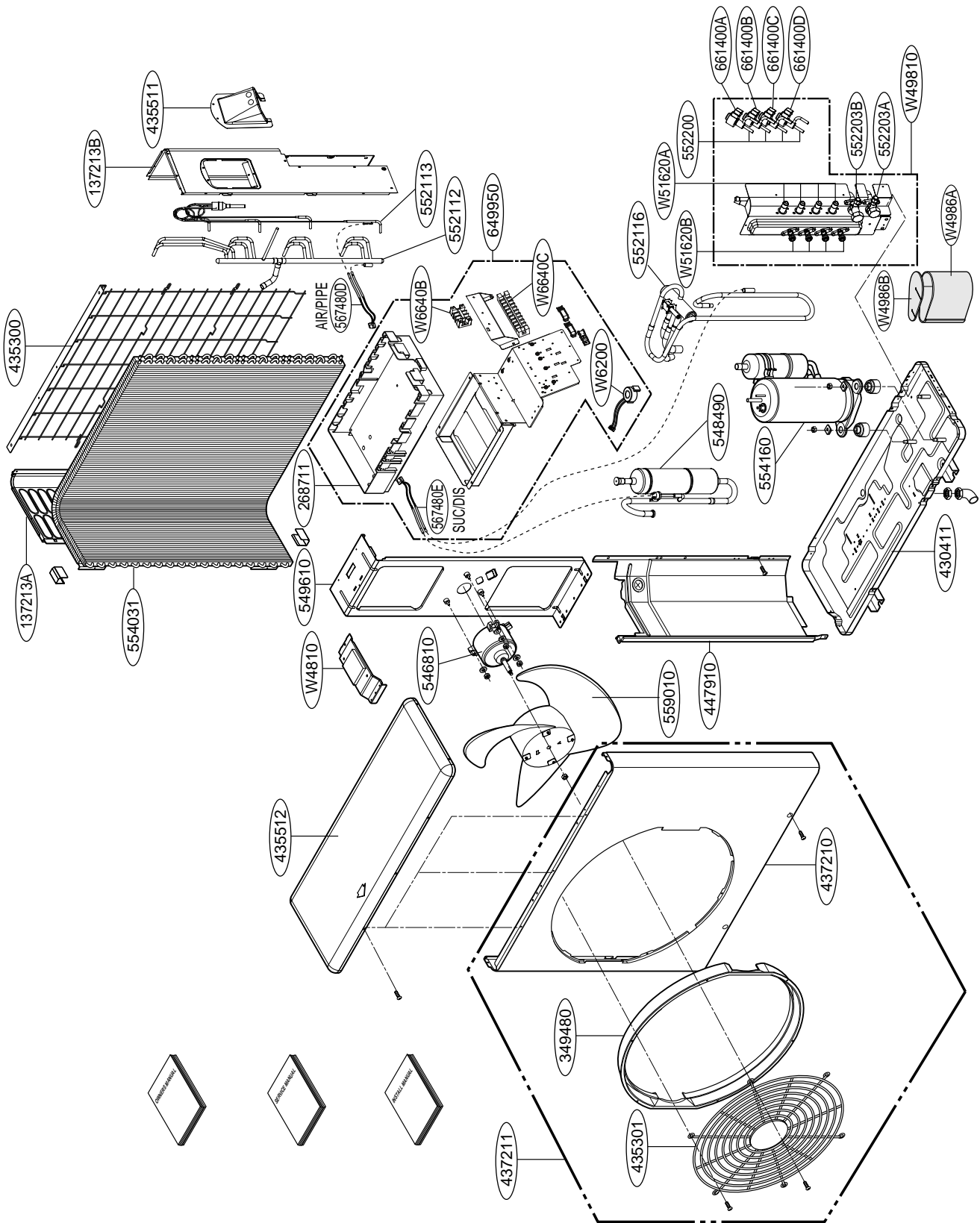

Note) * Please ensure GCSC since the replacement parts may be changed depending upon the buyer's request.
 Please check the correct parts in View RPL(Replacement Part List) on GCSC.
 (GCSC Website <http://biz.Lgservice.com>.)



P/NO : MFL61777602

FEBRUARY, 2009